

# XRAY 808

## INSTRUCTION MANUAL SUPPLEMENTARY SHEET

Use this XB808 Supplementary Instruction Sheet along with the standard XB808 instruction manual included in the kit. This Supplementary Sheet highlights and explains new updated steps and you should refer to them while building your XB808 kit. Each step in this Supplementary Sheet indicates the section to which the updated step refers.

### New and Improved Parts

All of these parts are new or updated from the previous versions. Each of these parts feature their corresponding part number which can be used to re-order the parts. You can also refer to the complete exploded views.

Please note that this kit does not include a turnbuckle tool. We recommend that you purchase the #181030 - 3mm, #181040 - 4mm and #181050 - 5mm HUDY Turnbuckle Tool.

## XB808 2009 SPEC



#358602 FUEL TANK 123CC - SET - V3



#358801 AIR FILTER SET - LOW PROFILE



#359704 XRAY XB808 BODY FOR 1/8 OFF ROAD BUGGY - LOW PROFILE



#353131 XB808 REAR UPPER INNER CAMBER LINK BALL JOINT - V2 (2)

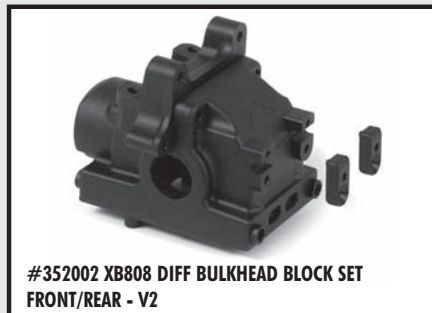

#352002 XB808 DIFF BULKHEAD BLOCK SET FRONT/REAR - V2



#352501 XB808 SERVO SAVER COMPLETE SET - V2



#358141 XB808 ALU SHOCK BODY NUT FOR SHOCK BOOT (2)



#358072 XB808 FOLDING SHOCK BOOT (4)



#358016 COMPOSITE SHOCK BALL JOINT FOR SHOCK BOOT (2)



#352664 XB808 COMPOSITE STEERING BALL JOINT 6.8MM - V2 (2)



#352151 XB808 FRONT UPPER ARM BALL JOINT - V2 (2)



#352665 XB808 COMPOSITE RELIEF STEERING BALL JOINT 6.8MM - V2 (2)



#351330 XB808 COMPOSITE REAR BODYPOST LONG



#352075 XB808 ALU BEARING COLLAR FOR DIFF BEARINGS (2)



#941320 HIGH-SPEED BALL-BEARING 13x19x4 RUBBER & STEEL SEALED (2)

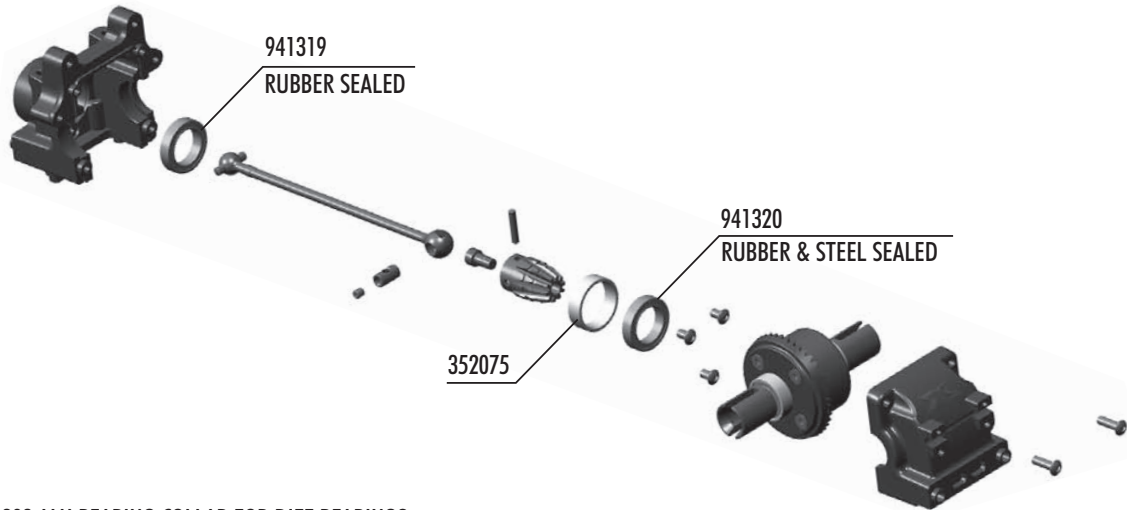

- #352075 XB808 ALU BEARING COLLAR FOR DIFF BEARINGS
- #941319 HIGH-SPEED BALL-BEARING 13x19x4 RUBBER SEALED (2)
- #941320 HIGH-SPEED BALL-BEARING 13x19x4 RUBBER & STEEL SEALED (2)

**1 step**

**TIP** Use HUDY Ball-Bearing Grease for servicing:  
 #106220 - Standard  
 #106221 - Extra  
 #106222 - Premium



**TIP** Follow the TECH TIP on page 5 for drive shaft pin servicing

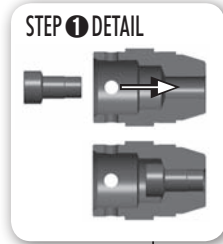

**TIP** Replace this pin when wear is present



**GR**  
 Graphite Grease (HUDY #106210)

**NOTE** # 941320 ORIENTATION  
 Install the ball-bearing with the STEEL seal facing inside the housing as shown.

**2 step**

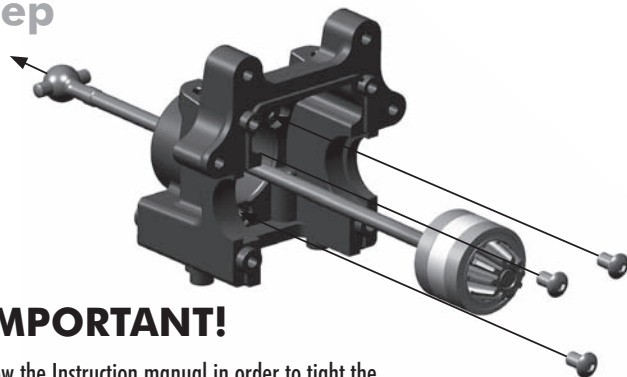

**IMPORTANT!**  
 Please follow the Instruction manual in order to tight the screws correctly.

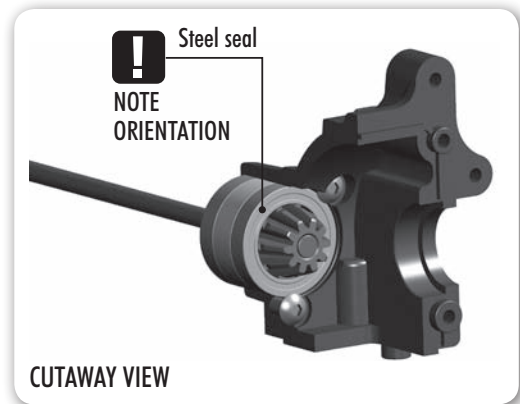

**1** step



971120  
O 12x1.6

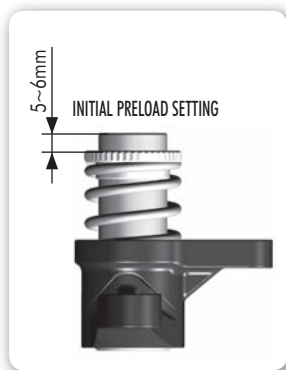

**9. FUEL TANK & ENGINE**

The new XRAY fuel tank — for all XB8 cars — has several new beneficial features.

The new included fuel tube holders may be connected to the tank by screws. These holders prevent the fuel tubes from moving around during racing and may prevent problems such as having the fuel tube contacting the flywheel.

The new fuel tank has the bigger fuel volume and includes optional tank inserts for decreasing the volume of the tank. Using the inserts allows you to adjust the volume of fuel inside the tank; this works in conjunction with variables such as fuel filter capacity and/or length of fuel line to ensure you are as close to the legal fuel volume limit as possible for racing.

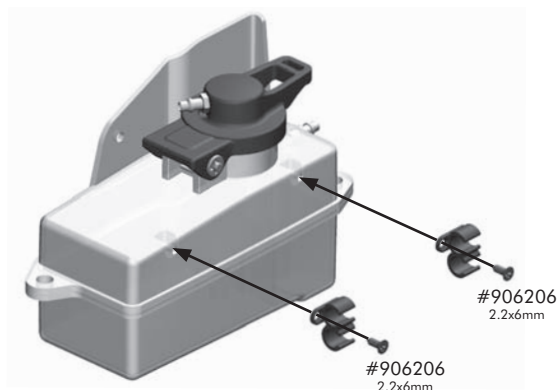

Tube holders are easily connected to the fuel tank by screws. The main advantage of this system is that the holders will never fall down as could happen when the glue is used.

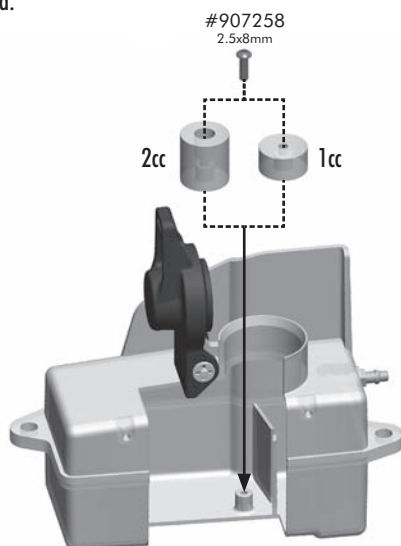

**2CC FUEL TANK INSERT**

The larger insert decreases the fuel tank volume by 2cc, and is recommended for use when the fuel filter is used.



NOTE ORIENTATION



**1CC FUEL TANK INSERT**

The smaller insert decreases the fuel tank volume by 1cc.



NOTE ORIENTATION

**NOTE:** The fuel tank insert can be easily mounted to the bottom of the fuel tank using the provided screw, when the fuel tank cap is opened fully.

**2x** FRONT SHOCKS (SHORT)

**2x** REAR SHOCKS (LONG)

There are two different thickness shims, use them as shown. Use the same procedure when building both front and rear shocks.

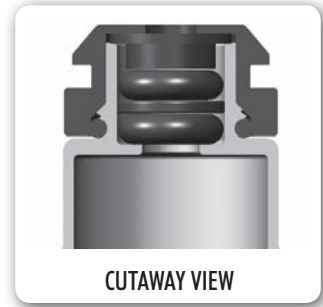
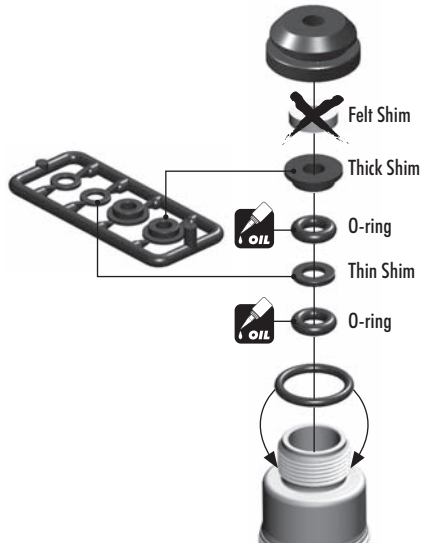

CUTAWAY VIEW

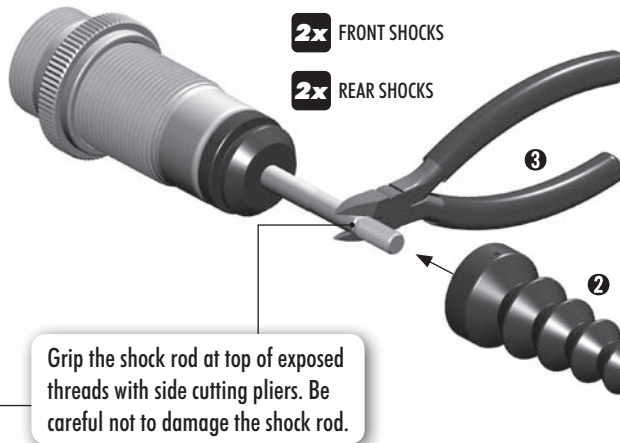

Grip the shock rod at top of exposed threads with side cutting pliers. Be careful not to damage the shock rod.

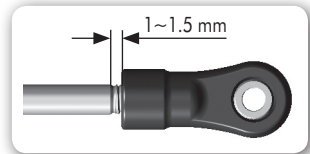

**TIP** Follow the TECH TIP on page 5 to install the pivot balls

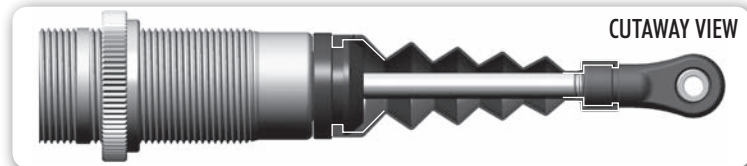

CUTAWAY VIEW

 Apply air filter oil and follow the engine instructions to service the air filter.

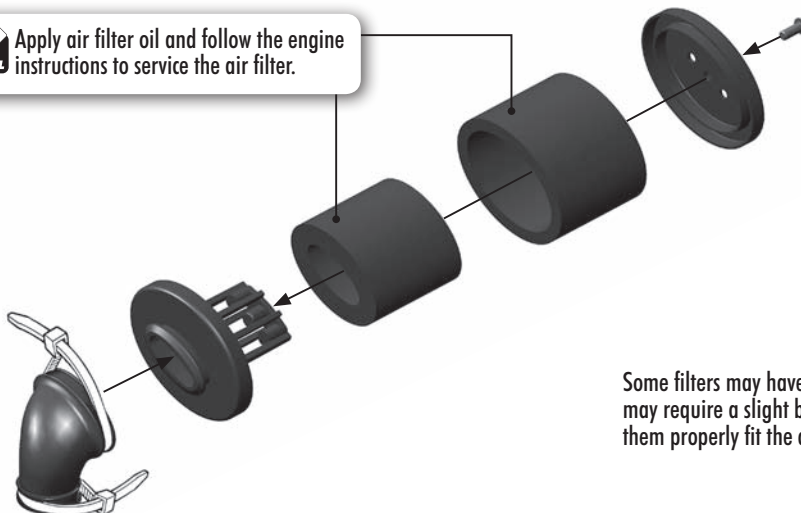

Some filters may have a round shape, and may require a slight bit of effort to make them properly fit the composite filter body.